

Upper End.

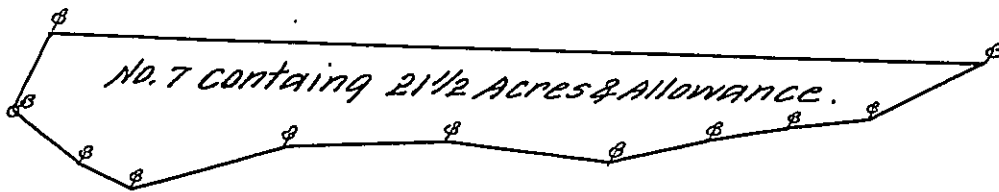

This Island in the River Susquehanna lies Below Berry's Falls in sight of them and very near the west side of the - contains Twenty one Acres and a half with the Usual Allowance.

Surveyed the 15th Novr for the Honble Proprietaries.

by Warrant of the } p John Armstrong.
13th October 1760 }

Returned into the Secretaries Office the 27th Day of June, 1763.
pr.

Courses and Distances
of No 7. Beging
Sycamore Upper End
N. 86. W. 15. Poplar.
S. 15 W. 15. Ash.
S. 5 W. 19 Hickory
S. 35 E. 32 Locust
S. 25 E. 36 B. O.
S. 17 E. 34 B. O.
S. 34 E 24 B. O.
S. 38 E. 16 Ash
S. 31 E. 17 Elm.
S. 45 E. 27 Hickory.
N. 22 W. 200 to
Beging.

IN TESTIMONY that the above is a copy of the original remaining on file in the Department of Internal Affairs of Pennsylvania, made conformably to an Act of Assembly approved the 16th day of February, 1833, I have hereunto set my Hand and caused the Seal of said Department to be affixed at Harrisburg, this twenty first day of June 1910

Neville Howard
Secretary of Internal Affairs.